



Hindmarsh Shire Council | PO Box 250 | 92 Nelson Street Nhill VIC 3418 | Ph: 03 5391 4444 |  
Fax: 03 5391 1376 | Email: [info@hindmarsh.vic.gov.au](mailto:info@hindmarsh.vic.gov.au)

---

22 July 2021

## **MEDIA RELEASE**

### **Rainbow Caravan Park Redevelopment Update**

Planning for the redevelopment of the Rainbow Caravan Park is progressing well with Hindmarsh Shire Council and electricity supplier Powercor currently working through the design stage of a power supply upgrade which will increase capacity at the Rainbow Recreation Reserve and Caravan Park.

The power upgrade will be the first stage of a multi-faceted project that will ultimately see the redevelopment of the Rainbow Caravan Park.

Hindmarsh Shire Council Mayor, Cr Ron Ismay said, "Council has allocated funding to upgrade the power supply into the Rainbow Recreation Reserve and Caravan Park".

"The power upgrade will provide sufficient power for future developments including the new joint use change rooms that will be located within the grounds of the caravan park but used by participants utilising the adjacent netball and tennis courts".

Powercor are expected to complete the design for the power upgrade by September 2021, with installation to take place from November 2021.

The design for the new female friendly change rooms have been submitted for building approval and it is hoped this will be finalised within the next few weeks. Once approved, the project will be advertised for tender and Council will seek to appoint a contractor to construct the new change rooms in last quarter of 2021 with an anticipated completion in mid-2022. Funding for the new change rooms has been provided by Sport and Recreation Victoria and Council.

Following the development of an initial Master Plan for the Rainbow Recreation Reserve / Caravan Park in 2018/2019, Council endorsed an approach by Wimmera Mallee Tourism in late 2020 to

review and redevelopment the Master Plan.

Cr Ismay said, “A number of interested Rainbow residents were approached to provide a local perspective and to assist the consultants with the re-development of the Master Plan for the Rainbow Caravan Park. They have subsequently provided invaluable input that has led to a range of key aspects being included into the Master Plan”.

Highlights of the master Plan include the following features:

- New entry into the Caravan Park via Swinbourne Avenue and the Recreation Reserve,
- Re-aligned and increased number of powered sites and roadways to enable easier and safer access for vehicles and caravans,
- New power heads and locations with connection to services,
- New location identified for future on-site self-contained cabin style accommodation,
- Upgrades to power and services, and
- Landscaping.

Copies of the Master Plan will be displayed at the Councils Customer Service Centre and in various shop windows throughout Rainbow.

“Whilst Council has allocated funds towards the upgrade of power to the Recreation Reserve and Caravan Park, further redevelopment will be carried out in stages and will be dependent upon available funding”, said Cr Ismay.

“Council is currently awaiting the outcome of a number of funding applications including one for new cabin style accommodation units and another to supply and install new services and power heads throughout the Caravan Park”, added Cr Ismay.

Rainbow residents are encouraged to provide comment on the Master Plan in writing to the Chief Executive Officer, Hindmarsh Shire Council, PO Box 250, Nhill Vic 3418 or via email to [info@hindmarsh.vic.gov.au](mailto:info@hindmarsh.vic.gov.au) by 2pm on Friday 20 August 2021.

For more information, please contact Phil King, Manager Economic and Community Development, on 03 5391 4444 or email [pking@hindmarsh.vic.gov.au](mailto:pking@hindmarsh.vic.gov.au).

---

Greg Wood  
**Chief Executive Officer**

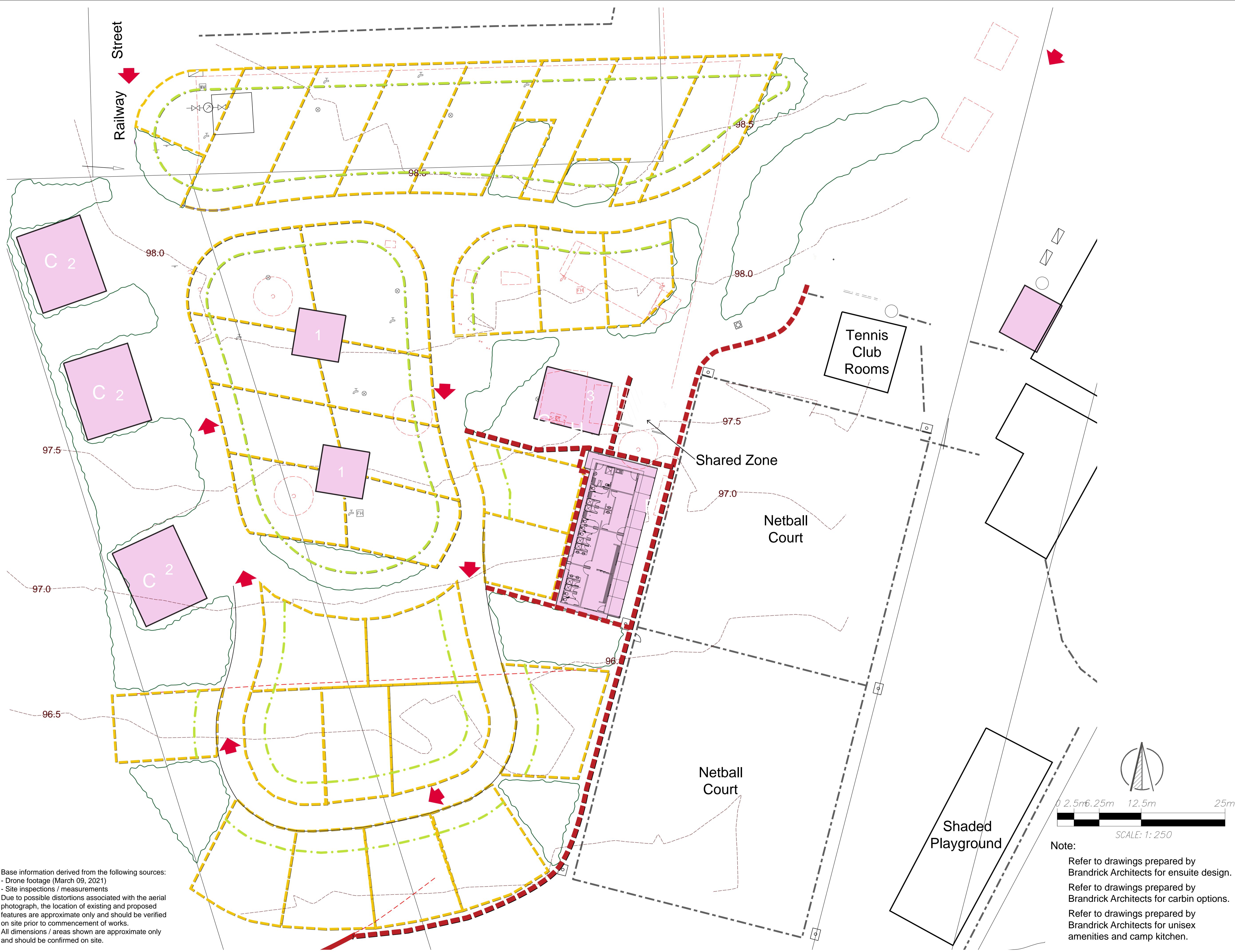

- LEGEND**
- Trees to be protected and retained
  - Contours @ 0.5m interval
  - Fence
  - Existing structure / building
  - Water tank
  - Existing gravel path to be retained
  - Demolition
  - Trees to be removed
  - Irrigated lawn
  - Site entry / exit
  - Access road
  - Proposed gravel path
  - Proposed tree
  - Proposed indigenous planting
  - Proposed caravan site
  - Sports court
  - Proposed cabin / building
  - Proposed car park
  - Picnic area / camp kitchen
  - Toilet / amenities
  - Proposed signage
  - Rubbish bin location
  - Proposed clear zone (see detailed caravan site plans)

Project:  
 Rainbow Caravan Park  
 Drawing Title:  
 Concept Plan  
 Prepared for:  
 Wimmera Mallee Tourism &  
 Hindmarsh Shire Council  
 Date: May 20, 2021  
 Scale: 1:250 @ A1 Sheet Size  
 Drawn: YL / GC / OJ  
 Checked: DH / HM  
 Drawing No: 2111-Rainbow- LP02

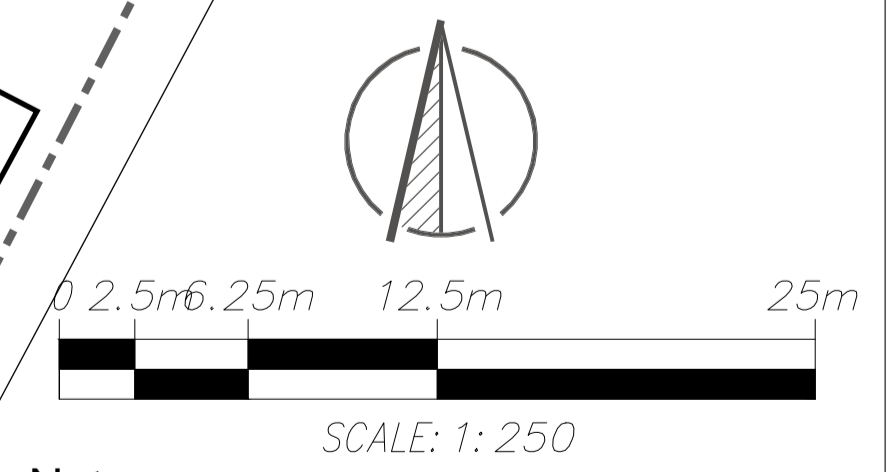

Note:  
 Refer to drawings prepared by Brandrick Architects for ensuite design.  
 Refer to drawings prepared by Brandrick Architects for cabin options.  
 Refer to drawings prepared by Brandrick Architects for unisex amenities and camp kitchen.

Base information derived from the following sources:  
 - Drone footage (March 09, 2021)  
 - Site inspections / measurements  
 Due to possible distortions associated with the aerial photograph, the location of existing and proposed features are approximate only and should be verified on site prior to commencement of works.  
 All dimensions / areas shown are approximate only and should be confirmed on site.